

# PAUL QUANG

curriculum vitae

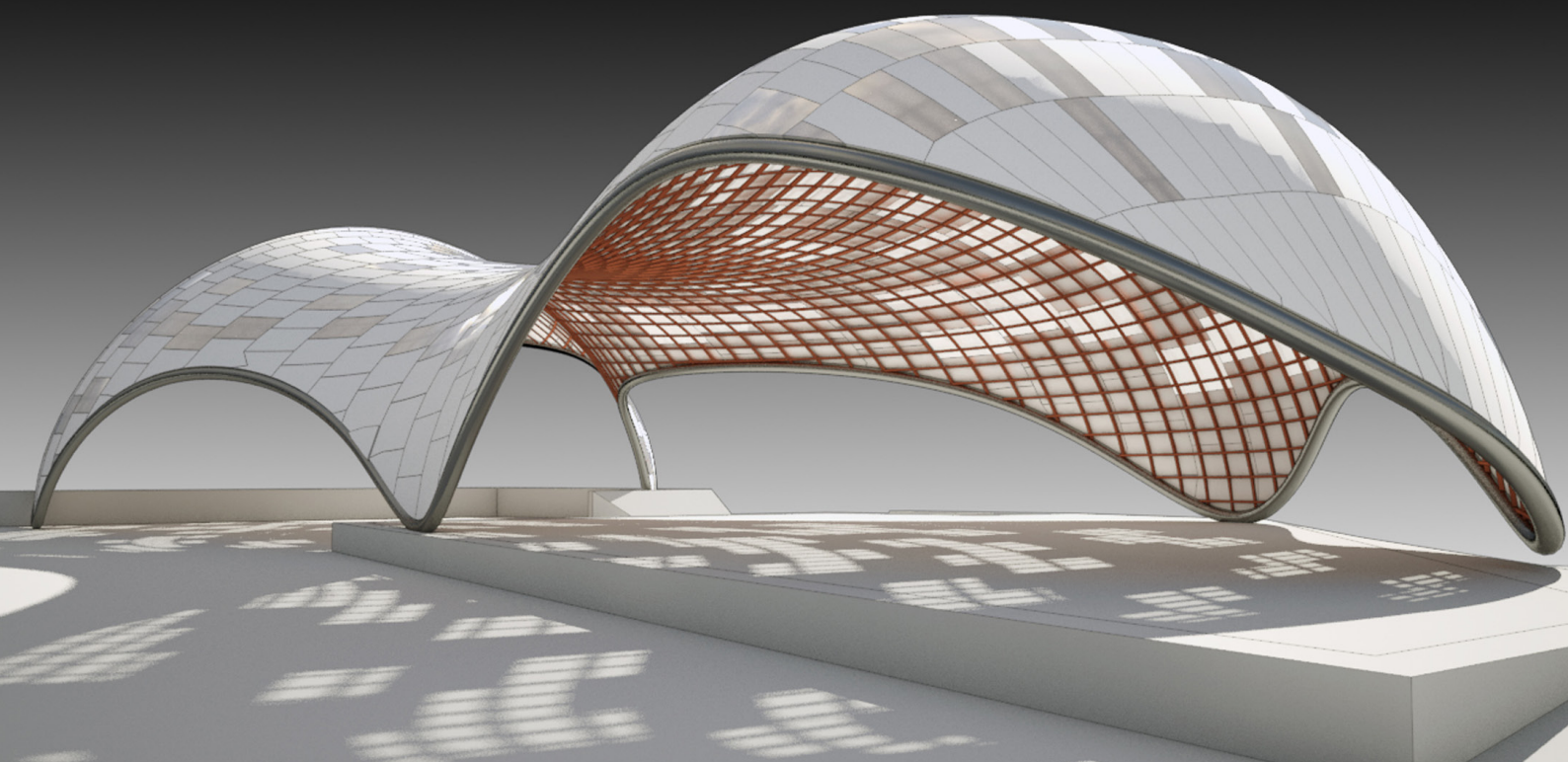

# PAUL QUANG

Kuglerstrasse 5, Berlin 10439 + 49 17681360182 paul\_quang@yahoo.com.au

Associate Director and Design Lead, with all-round, international experience delivering prominent architecture of a high design level, with expertise in nearly all sectors. I have a Bachelor of Architecture from the University of Melbourne 2000, I am a registered Architect in Australia, and I have been practicing for over sixteen years in New York City, Tokyo, London, Melbourne and Berlin. I have also been an associate tutor at Monash University, teaching architecture and structures.

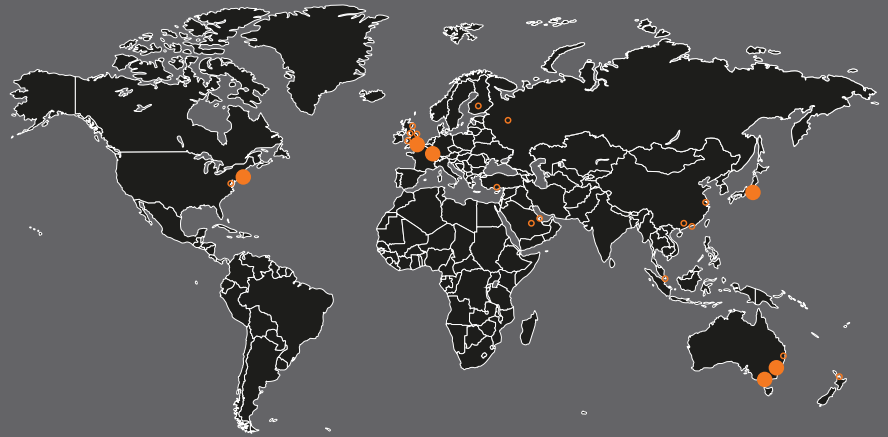

- 10 REGISTERED ARCHITECT**  
ARBV, VICTORIA, AUSTRALIA
- 00 BACHELOR OF ARCHITECTURE**  
UNIVERSITY OF MELBOURNE, AUSTRALIA
- 97 BACHELOR OF ENVIRONMENT DESIGN**  
UNIVERSITY OF CANBERRA, AUSTRALIA
- 75 BORN**  
11 SEPTEMBER, HOBART, AUSTRALIA
- 15 ASSOCIATE DIRECTOR GERBER ARCHITEKTEN** BERLIN, GERMANY CURRENT
- 10 PROJECT LEADER GRIMSHAW ARCHITECTS** MELBOURNE, AUSTRALIA, 5 YEARS
- 09 PROJECT LEADER DENTON CORKER MARSHALL** LONDON, UK, 1 YEAR
- 07 PROJECT LEADER WILKINSON EYRE ARCHITECTS** LONDON, UK, 2 YEARS
- 04 DEPUTY PROJECT LEADER ANDREW LETT ARCHITECTS** LONDON, UK, 3 YEARS
- 03 ARCHITECTURAL DESIGNER ENDOH ARCHITECTS** TOKYO, JAPAN 10 MONTHS
- 00 ARCHITECTURAL GRADUATE COY + YIONTIS** MELBOURNE, AUSTRALIA 3 YEARS
- 97 ARCHITECTURAL STUDENT MITCHELL GIURGOLA** NYC, USA, 6 MONTHS

- |   |   |   |   |   |   |
|---|---|---|---|---|---|
| ● | ● | ● | ● | ○ | <b>PROJECT ACQUISITION</b> BUSINESS DEVELOPMENT, BIDS, COMPETITIONS |
| ● | ● | ● | ● | ○ | <b>PROJECT MANAGEMENT</b> FEES, RESOURCES, PROGRAMMES               |
| ● | ● | ● | ● | ● | <b>CONCEPT DESIGN</b> HAND SKETCHING, RHINO, CREATIVE SUITE         |
| ● | ● | ● | ● | ● | <b>DOCUMENTATION</b> REVIT, CAD, DETAILING                          |
| ● | ● | ● | ● | ● | <b>PROJECT DELIVERY</b> SHOP DRAWING REVIEW, SITE ADMINISTRATION    |
| ● | ● | ● | ● | ○ | <b>R&amp;D</b> TIMBER STRUCTURES, FABRICATION, COMPUTATIONAL DESIGN |

## Gerber Architekten International

Associate Director – Design Lead



### Olaya Metro

New Underground Metro and Retail Centre, Riyadh, Saudi Arabia, \$1.1B, 68 000sqm 2015

Project Architect of team of 20 architects, delivering all design services for a major iconic station comprising of advanced rail transfer platforms, 11 000 sqm of high end retail and a 20 000 sqm public roof park. The role in a Design and Build Contract, directly dealing with the Contractor, the Client Owner, and the JV Consultant team.



### Shanghai Pudong Football Stadium

Competition for New 50 000 seat Top Class Football Stadium, Shanghai, China, 2016

Project Lead to design new world class football stadium for SIPG FC and masterplan of surround area as mixed-use development and recreational park.

## Grimshaw Architects

Senior Project Architect



### 699 Bourke Street

New Office HQ Building, Melbourne, Australia \$120M, 19 000sqm 2014

Project Architect from competition design to site delivery of a new build commercial tower over an existing rail environment. Besides leading the team, I also ran structural steel and façade packages involving complex and detailed design and documentation in a fast tracked programme, with close collaboration with consultants and subcontractors.



### Highpoint Retail Centre

New Retail Precinct, Melbourne, Australia, \$200M, 30 000 sqm 2013

Team Leader, for the design, documentation and site delivery of a new retail street to an existing centre. Main focus was the design of a timber shell roof structure, with close collaboration with the specialist engineers and timber contractors.



### Docklands Masterplan

Analysis of current scenario, and proposal for strategic plan for basin and transport orientated development, with high level concept proposals. Met with governing bodies, developers and key planning figures to deliver a report for future actions.

Lead design and primary author of document.

## Wilkinson Eyre Architects

Project Leader



### Grosvenor Place

New Mixed Use Development, London,UK \$475M, 30 000sqm 2007

Project Leader for schematic design of office, high-end residential and hotel schemes. Directly involved with ongoing presentations to Client, and Trustees (Duke of Westminster) for sensitive planning consultation. Coordinated a full consultant design team including heritage and town planning consultants.



### 20 Blackfriars Road

New Commercial and Residential Towers, \$380M, 80 000sqm 2008

Project Leader to fulfill the design development of a commercial tower, residential tower, and affordable housing block. Lead a full consultant design team and liaised directly with the Client. Drove a value engineering study on apartment layouts, core design, basement layouts, a complex façade design and construction while maintaining the key design.



### Oxford University School of Public Policy

Competition for New Faculty Building

Team Leader for Competition for design of university faculty building including tutorial rooms, offices, auditoriums, canteen, executive function centre and library.

## Andrew Lett Architects

Deputy Project Leader



### BP Headquarters

New Commercial Campus Building, Aberdeen, United Kingdom \$110M, 22 000sqm 2007

Team member in winning competition scheme, to become deputy to the Project Architect for all stages up to completion. Team member for Shell and Core packages and on site administration as well as lead interior packages. A tight contractor's programme, involving intensive coordination of consultants, contractors and specialist sub contractors



### Rainton Bridge

New Business Park Sunderland, United Kingdom, \$20M, 11 000 sqm 2005

Deputy to the Project Architect for all stages up to completion for a cost effective, fast tracked Design and Build contract, Shell and Core works. Assisted the Project Architect on the building envelope and core packages and on site administration as well as lead the internal packages to have an award winning project.